

Nakta Pointer

USER MANUAL



Nakta | MAKRO
DETECTION TECHNOLOGIES

Authorized
R&D CENTER

Nokta Pointer

USER MANUAL

Device Introduction

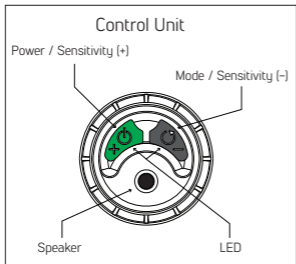

IP Rating:

IP67 – Dust resistant and waterproof up to 1 meter depth.

WARNING!

Wash the pointer with tap water after using it in salty water.

Do not use any chemicals for cleaning and/or for any other purposes.

Never insert any hard or sharp objects into the buzzer hole.

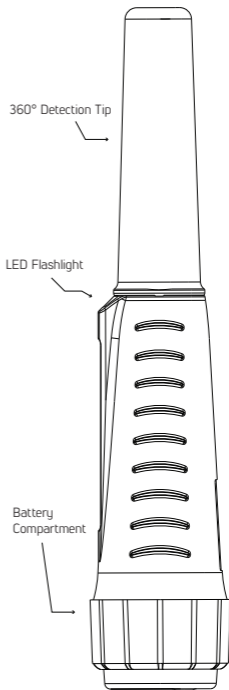

Battery Installation

A) To install the battery, twist and remove the fastener marked with number 1.

B) To remove the control unit marked with number 2 from the device, pull WITHOUT TWISTING.

C) Insert the battery facing downwards paying attention to plus (+) and minus (-) poles. The device will not work if the battery is not installed correctly.

D) To mount the control unit (2) back on the device, align the contact pins and the notches marked with number 3 and push to snap in. DO NOT TWIST THE CONTROL UNIT!

E) Twist the fastener (1) and do not leave it loose to secure a water tight seal.

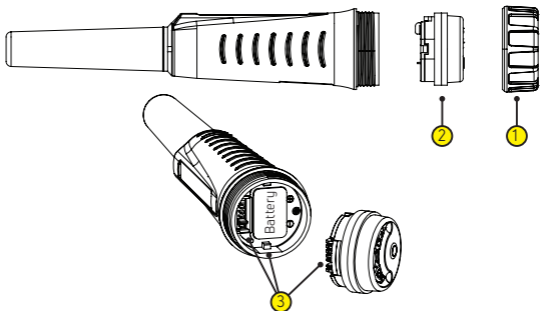



Turning on the Device

Press the green button once. The LED will light up and a long warning tone will be heard. Nokta Pointer is ready for use. Be sure there are no metal objects around at start up.



Turning off the Device

Press and hold the green button. Six (6) short warning tones will be heard and the device will turn off.



Mode Change

Press the gray button for 3 seconds. A short warning tone will be heard. The device will switch from the audio mode to the vibration mode. When pressed and held again, it will switch to the audio and vibration mode. If pressed again, it will revert back to the audio mode. A short warning tone will be heard with each mode change. Nokta Pointer will start at the same setting the next time you start up the device.



Sensitivity Increase

Sensitivity has ten (10) levels. The factory preset is level 5. Click the green button to increase sensitivity. The device will indicate the sensitivity change with a short beep each time you click the green button. When maximum sensitivity is reached, the device will produce a long beep.



Sensitivity Decrease

Click the gray button to decrease sensitivity. The device will produce a short beep each time. When minimum sensitivity is reached, the device will produce a long beep. Nokta Pointer will start at the last adjusted sensitivity level next time it is turned on.

Lost Alarm & Auto-Shut Off

After 5 minutes of inactivity, the pinpointer will emit an audible alarm and LED will start flashing. After 5 minutes of alarm, the device will shut off automatically to save battery life.

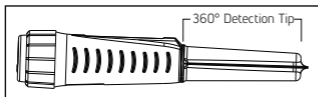

Detection Tip

Nokta Pointer's detection area is between the tip and the hand grip. The coil provides 360° detection. This

helps you to locate targets quickly and easily in the hole. If you hold the device horizontally, you can scan a larger area. This allows you to cover a broader area to quickly reach your target.



LED Flashlight

Press the green and gray buttons simultaneously to turn it on, press again to turn off. Nokta Pointer will start at the same setting at start up.

Low Battery Indicator

When the battery is low, Nokta Pointer will give 5 short-long beeps at start up. The device may continue to work for a short period of time.

Replaceable Hard-Shell Cases

Nokta Pointer comes with two hard-shell cases. One of the cases is also designed to allow for digging.

Coil Interference Blocking

When it is switched off, it disconnects the coil's magnetic transmission and eliminates interference with another metal detector. This also prevents the device from being detected as a target.

Usage

When a target is detected, Nokta Pointer will produce an audio and/or vibration alert. The rate of the pulsing audio or vibrations will increase as it gets closer to the target and it will decrease as it is moved away.

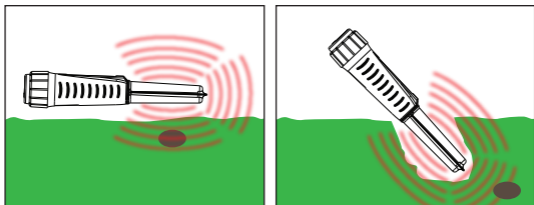

TECHNICAL SPECIFICATIONS

Working Frequency	: 18.2 kHz
Metal Detection	: Audio and/or vibration alert
Sensitivity	: User adjustable
Auto-Shut Off	: Yes
Coil Interference Blocking	: Yes
Dimensions	: 24 x 4.8 x 4.8cm (9.4" x 1.9" x 1.9") (including the hard-shell digger case)
Detection Tip	: 9.3cm (3.7")
Weight	: 235gr (8.3oz) (including the battery and hard-shell digger case)
Working Temperature	: -20°C/+50°C (-4°F/+122°F)
Battery	: 9V Alkaline Battery
Battery Life	: Up to 30 Hours

Nokta | MAKRO

DETECTION TECHNOLOGIES

www.noktadetectors.com

